

LOC		DIST		REVISIONS				DATE	APPD
AA	22	P	F	ZONE	LTR	DESCRIPTION			
					H	REV; EC 0502-0711-97	23OCT97	DS EL	

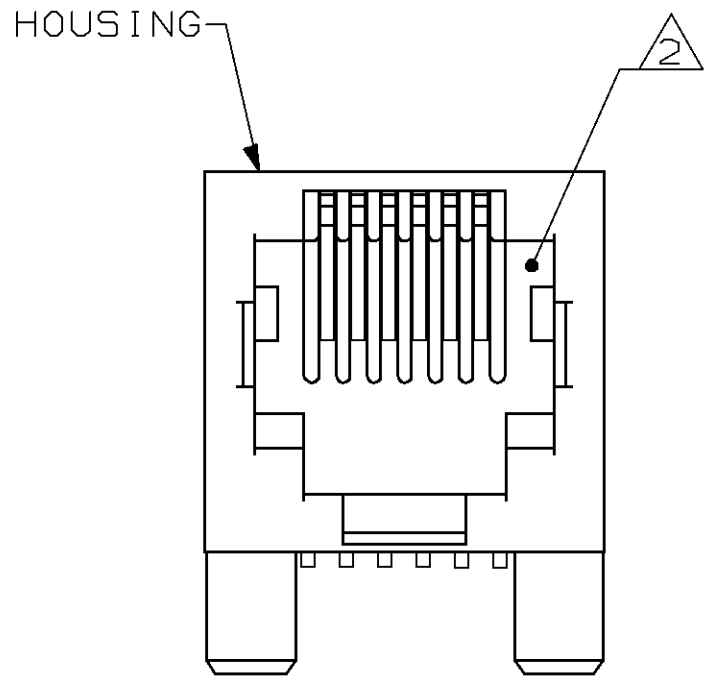

- 1 MATERIAL: HOUSING- HTN MOLDING COMPOUND, 94V0, BLACK.
 TERMINAL- 0.35 [.0138] THICK PHOS BRONZE PLATED WITH 1.27µm [.000050] THICK HARD GOLD IN LOCALIZED GOLD PLATE AREA AND 2.03µm [.000080] THICK TIN-LEAD IN SOLDER AREA OVER 1.27µm [.000050] THICK NICKEL UNDERPLATE.
- 2 CAVITY CONFORMS TO FCC RULES AND REGULATIONS PART 68, SUBPART F.
- 3. SNAP-IN RETENTION FEATURE ACCOMMODATES A 1.57±0.13 [.062±.005] PRINTED CIRCUIT BOARD.
- 4 DIMENSIONS ARE MAXIMUM UNLESS OTHERWISE SPECIFIED AND ARE PRIOR TO SURFACE MOUNT PROCESSING.
- 5 TERMINALS SHALL BE ASSEMBLED IN CENTER POSITIONS FOR -2.
- 6 - 2 PACKAGED 42 ASSEMBLIES PER TUBE.

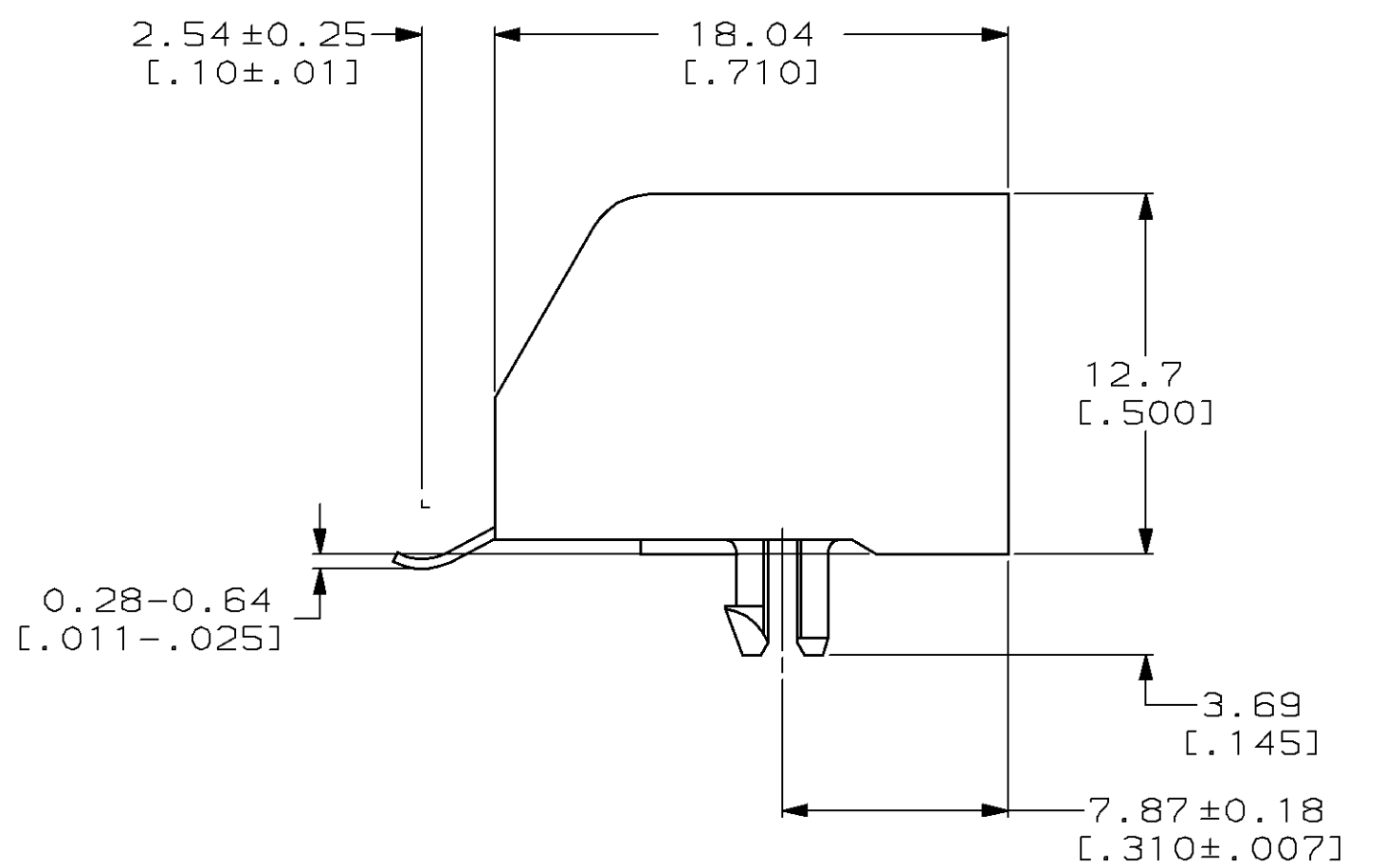
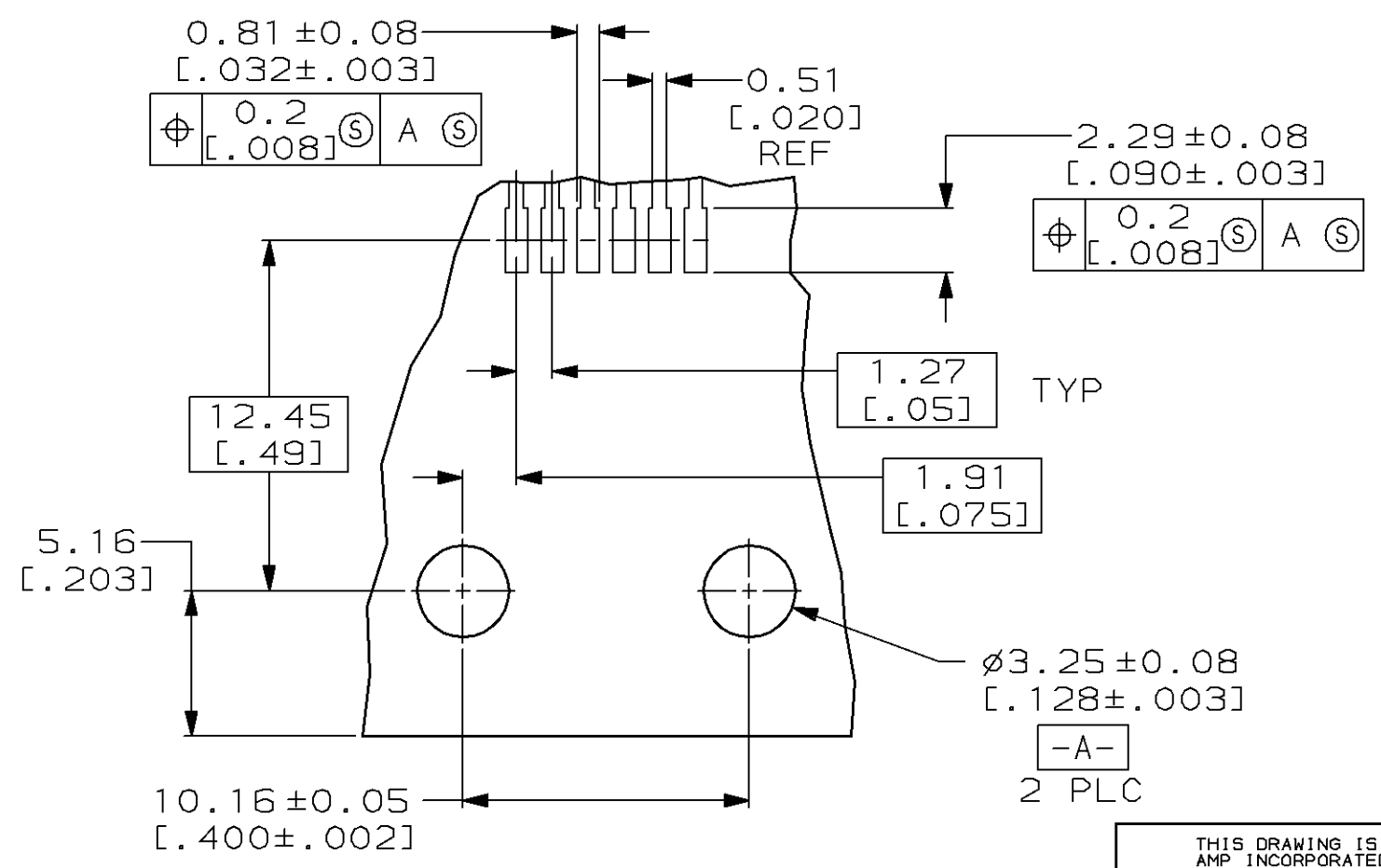
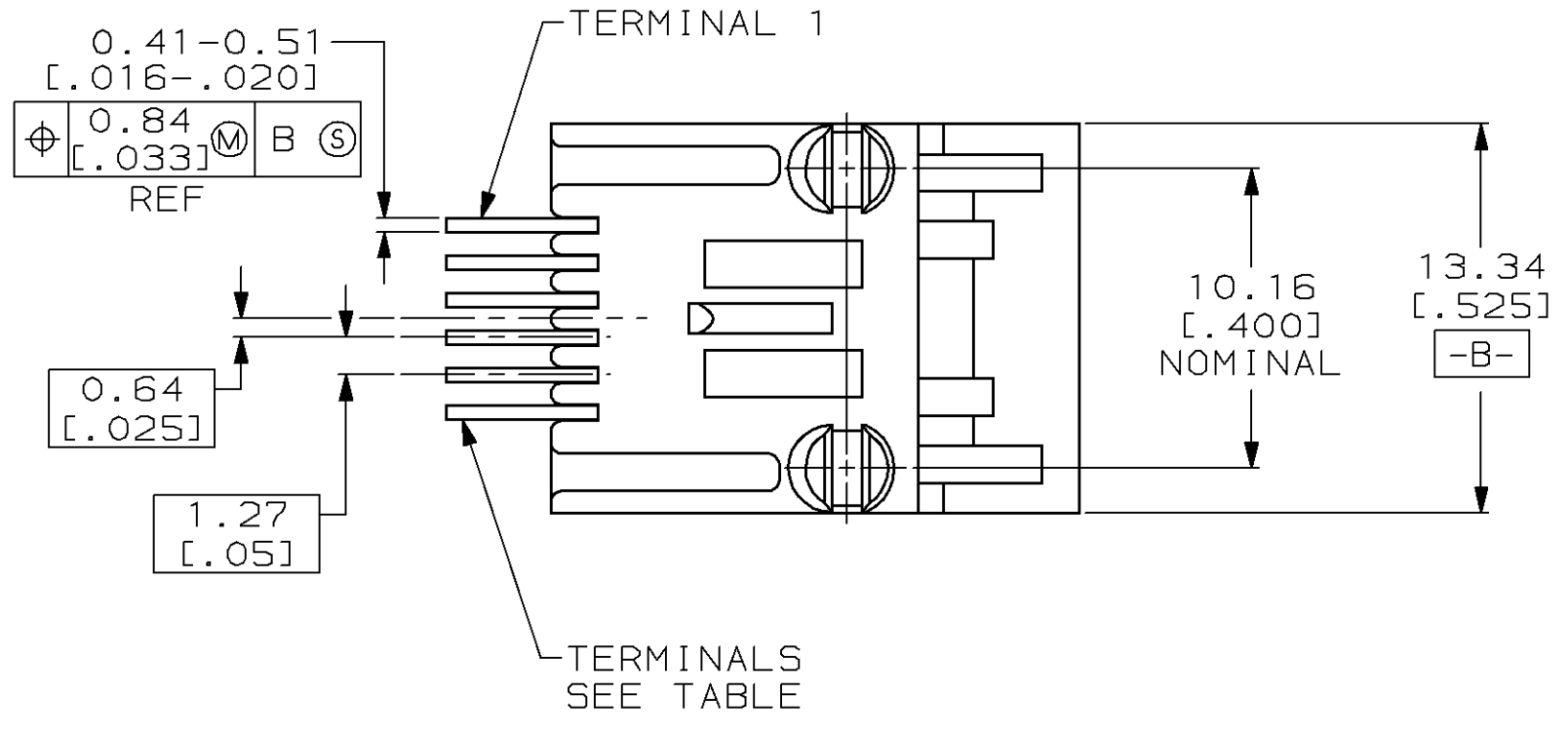

DO NOT SCALE PRINT. UNLESS SPECIFIED DIMENSIONS IN mm [INCHES] TOLERANCES ON:		DR 12-05-94 L. SMITH		4 557314-2		6 557314-1	
2 PLC DEC ± - 4		CHK 12-09-94 C.WHITT		TERMINALS REQUIRED		PART NO	
3 PLC DEC ± -		APPD 12-16-94 J.TONEY		AMP Incorporated Harrisburg, PA 17105-3608			
ANGLES ± -		APPD 12-16-94 H.MCGRATH					
MATERIAL 1		PRODUCT SPEC 108-1163		NAME MODULAR JACK ASSEMBLY, 6 POSITION, LOW PROFILE, RIGHT ANGLE, SURFACE MOUNT			
FINISH 1		APPLICATION SPEC 114-6040		SIZE C	CAGE CODE 00779	DRAWING NO G=557314	
		WEIGHT -		SCALE 4:1	SHEET 1 OF 1		

THIS DRAWING IS A CONTROLLED DOCUMENT FOR AMP INCORPORATED. IT IS SUBJECT TO CHANGE AND THE CONTROLLING ENGINEERING ORGANIZATION SHOULD BE CONTACTED FOR THE LATEST REVISION.